

GypKaP February 7-8, 2009 at Key Ranch (Boot Ranch)

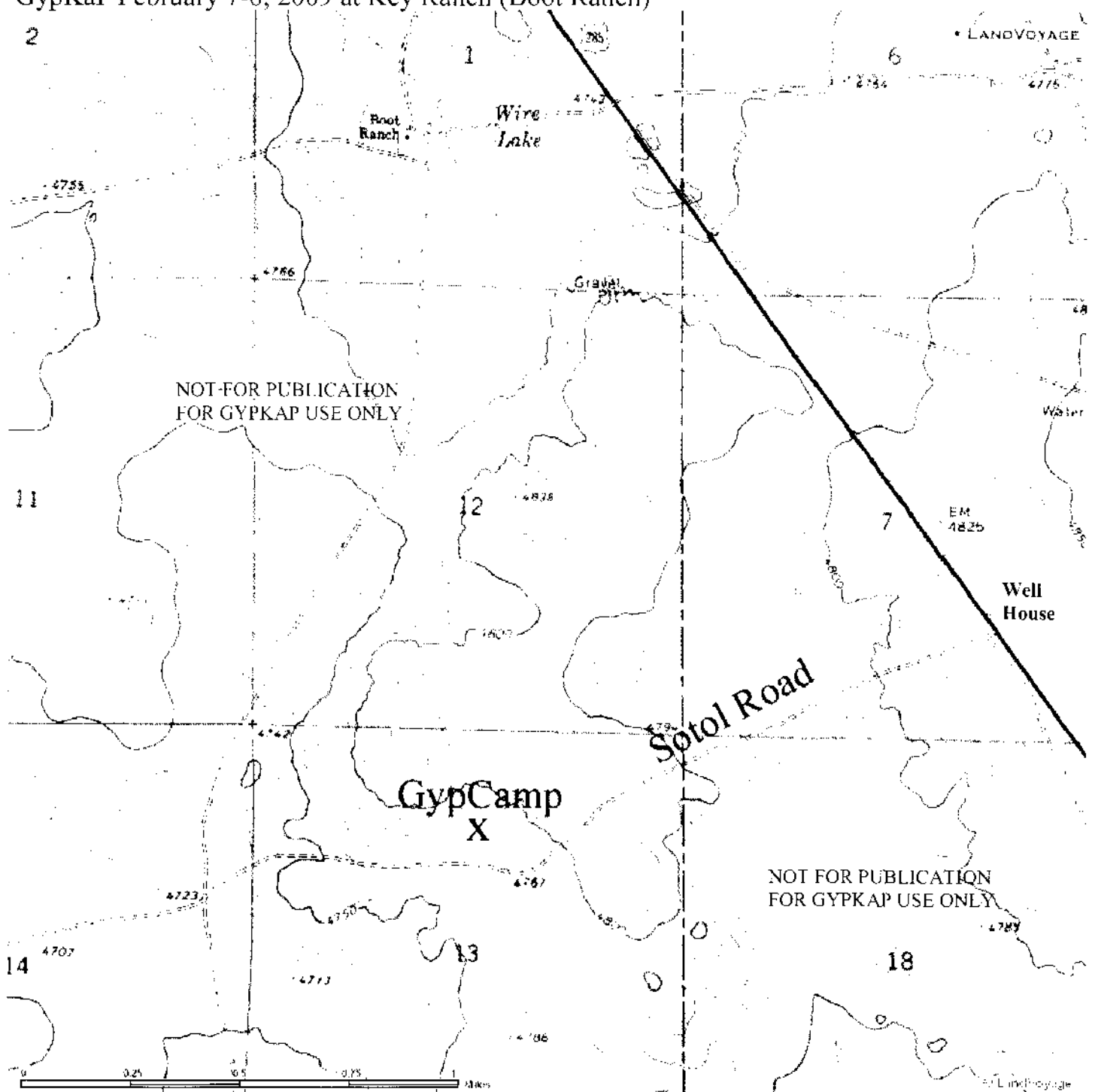

At this GypKaP weekend we will be camping on the Boot Ranch and visiting caves within the Area. If the weather forecast holds for little to no rain but cold temperatures it will be a typical winter camping on the Gypsum Plains. I'll be setting up the GypTent and the heater and will probably have a fire if the wind cooperates. The GypBeacon will be out as well marking the camping spot. The area is located just south of the intersection of highway 247 (Corona highway) and highway 285 from Roswell (south) or Vaughn (north). Sotol Road is approximately 5.5 miles south of the intersection. The well house is on the east side of highway 285. Directly across to the west is Sotol Road. I have many caves for you to survey. So come out and sharpen up those surveying skills. See you out there for those who can make it. Call for more information call or text at 505.362.0101 cell.